

Base Box

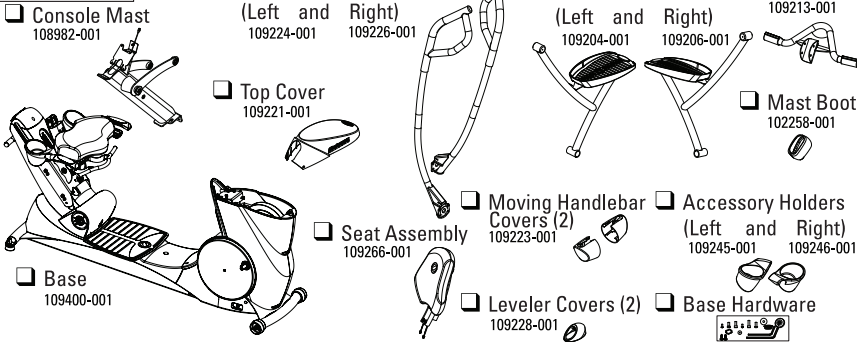

Console Box

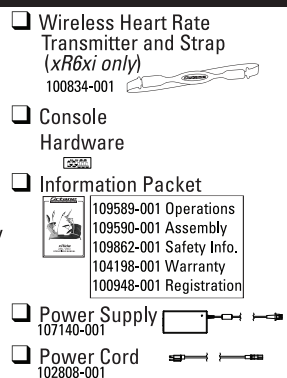
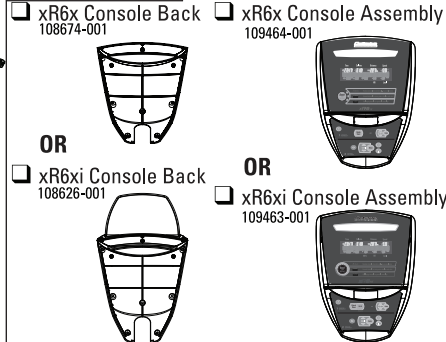

Base Hardware

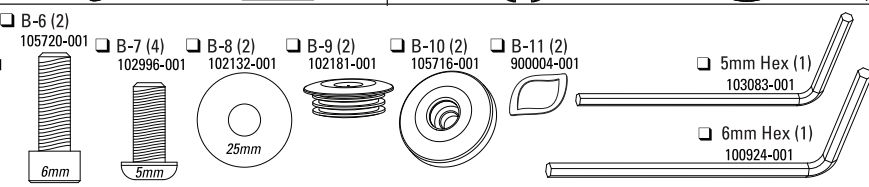
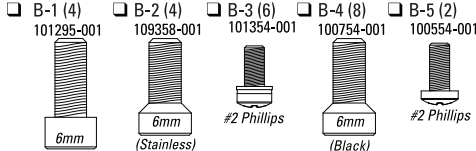

Console Hardware

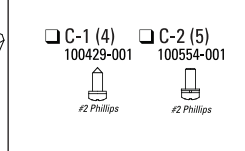

A Console Mast & Console Assembly

- Slide mast over screws on base; insert B-1 (Qty 2); tighten all 4 screws (30 ft-lb).
- Connect cable (mast to base).
- Connect console cables (2) and ground cable. Slide console assembly over front support and onto console mast; attach with C-1 (Qty 4). Connect power supply to unit; connect power cord to power supply and to power outlet. Verify that console LEDs light, then disconnect power cord from power outlet.
- Align console back with console assembly. Snap console back and console assembly together at top. Secure console back with C-2 (Qty 5).

B Seat Assembly

- Connect cables in seat assembly post to base cables (2).
- Slide seat assembly post into base. Attach seat assembly with B-2 (Qty 4) and tighten with 6mm hex to 17 ft-lb.
- Attach accessory holders with B-3 (Qty 3 each).

C Moving Handlebars

For each moving handlebar:

- Attach moving handlebar at hub with B-4 (Qty 4); tighten with 6mm hex to 30 ft-lb.
- Slide handlebar cover over moving handlebar base.

OPTIONAL—Adjust moving handlebar for 1" longer or shorter reach:

- Remove lower panel.
- Hold handlebar**, remove and reposition bolt.
- Replace lower panel.

Settings on both handlebars must match.

D Top Cover & Mast Boot

- Attach top cover with B-5 (Qty 2).
- Wrap mast boot around console mast.

E Foot Pedals & Foot Rest

- Position lower foot pedal hub with B-11 (Qty 1).
- Attach upper foot pedal hub with B-6 and B-10 (Qty 1).
- Attach lower hub with B-8 and B-1 (Qty 1). Press B-9 in hub. Repeat 1-3 for second foot pedal.
- Attach foot rest to console mast with B-7 (Qty 4).

F Level & User Set-up

- Adjust and lock levelers; **make sure nut is tight.**
- Press leveler covers over stabilizer bar.
- Connect power supply to unit; connect power cord to power supply and to power outlet.
- Complete User Set-up (press & hold Level (▲/▼)) — Instructions in Operations Manual.